

| R E V I S I O N S | | |
|-------------------|---------|--|
| NO. | DATE | DESCRIPTION |
| A | 1-2-72 | PREPARED |
| B | 3-13-72 | PLATE BARRIERS ADDED |
| C | 6-12-72 | DELETED ESCALATOR NO. 2 AND CHANGED NORTH WALL OF ESCALATOR TO MATCH DRAWING ON 2D |
| D | 9-13-72 | ESCALATOR NUMBERING WITH ALIAS |
| E | 4-12-73 | REVISED HATCHING ON 2D 55-44-2K MAP |

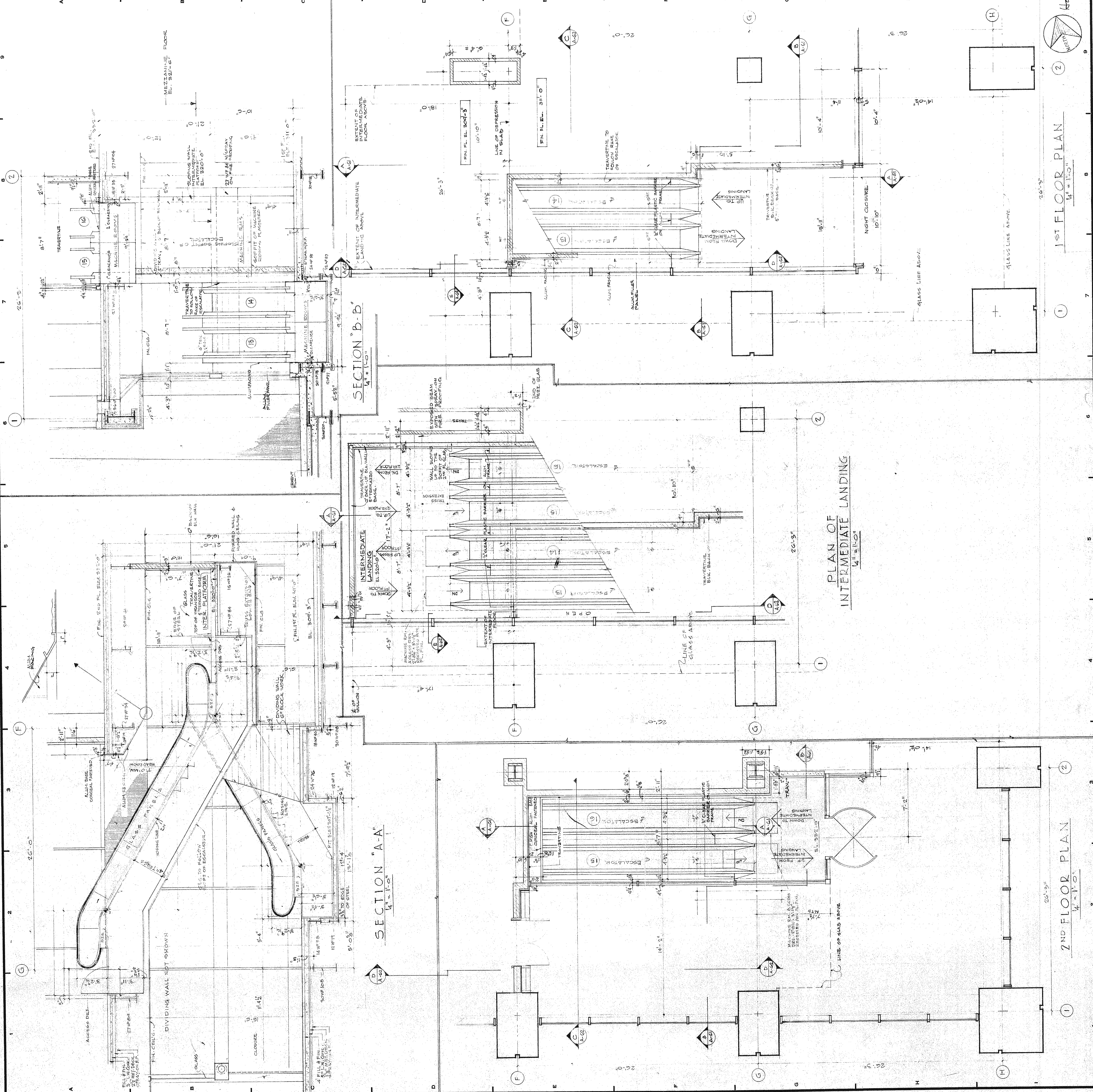

SECTION "B-B"
1/4" = 1'-0"

SECTION "A-A"
1/4" = 1'-0"

PLAN OF INTERMEDIATE LANDING
1/4" = 1'-0"

2ND FLOOR PLAN
1/4" = 1'-0"

1ST FLOOR PLAN
1/4" = 1'-0"

| REV. | NO. | DATE | DESCRIPTION |
|------|-----|---------|--|
| 1 | 1 | 1-2-72 | PREPARED |
| 2 | 2 | 3-13-72 | PLATE BARRIERS ADDED |
| 3 | 3 | 6-12-72 | DELETED ESCALATOR NO. 2 AND CHANGED NORTH WALL OF ESCALATOR TO MATCH DRAWING ON 2D |
| 4 | 4 | 9-13-72 | ESCALATOR NUMBERING WITH ALIAS |
| 5 | 5 | 4-12-73 | REVISED HATCHING ON 2D 55-44-2K MAP |

**BANKERS TRUST
PLAZA**

**A FISHER BROTHERS
PROJECT**

GREENWICH AND LIBERTY ST. N.Y. N.Y.

SHREVE, LAMB & HARMON ASSOCIATES P.C.
ARCHITECTS
475 PARK AVENUE SOUTH N.Y. N.Y. 10016

PETERSON AND BRICKBAUER
ASSOCIATED ARCHITECTS
919 THIRD AVENUE N.Y. N.Y. 10022

THE OFFICE OF JAMES RUDERMAN
STRUCTURAL ENGINEERS
315 MADISON AVENUE N.Y. N.Y. 10022

J. A. ROSS, BAUM & BOLLES
MECH. & ELEC. ENGINEERS
345 PARK AVENUE N.Y. N.Y. 10022

ESCALATOR DETAILS
SHEET No. 2
ESCALATORS # 15, 14, 15, 16

PROJECT NUMBER
7101

DRAWING NUMBER
A 61

DATE
DEC. 9, 1971

SCALE
AS SHOWN

