

REVISIONS		
NO.	DATE	DESCRIPTION
A	11-11-71	GENERAL REVISION
B	9-16-72	ADDED TO THE ENCLOSURE K.O. 411 BC
C	6-22-73	ADDED NOTE ON VAN
D	7-24-72	ADDED TO THE ENCLOSURE K.O. 411 BC
E	8-24-72	ADDED TO THE ENCLOSURE K.O. 411 BC
F	1-19-73	ADDED TO THE ENCLOSURE K.O. 411 BC
G	4-12-73	ADDED TO THE ENCLOSURE K.O. 411 BC
H		

ISSUED TO	NO.	DATE	PAGE NO.
ST. LO.	1	1-13-72	PC 55298
ST. LO.	2	2-13-72	PC 55142
ST. LO.	3	2-22-72	PC 55142
ST. LO.	4	2-22-72	PC 55142
ST. LO.	5	2-22-72	PC 55142
ST. LO.	6	2-22-72	PC 55142
ST. LO.	7	2-22-72	PC 55142
ST. LO.	8	2-22-72	PC 55142
ST. LO.	9	2-22-72	PC 55142
ST. LO.	10	2-22-72	PC 55142
ST. LO.	11	2-22-72	PC 55142
ST. LO.	12	2-22-72	PC 55142
ST. LO.	13	2-22-72	PC 55142
ST. LO.	14	2-22-72	PC 55142
ST. LO.	15	2-22-72	PC 55142
ST. LO.	16	2-22-72	PC 55142
ST. LO.	17	2-22-72	PC 55142
ST. LO.	18	2-22-72	PC 55142
ST. LO.	19	2-22-72	PC 55142
ST. LO.	20	2-22-72	PC 55142
ST. LO.	21	2-22-72	PC 55142
ST. LO.	22	2-22-72	PC 55142
ST. LO.	23	2-22-72	PC 55142
ST. LO.	24	2-22-72	PC 55142
ST. LO.	25	2-22-72	PC 55142
ST. LO.	26	2-22-72	PC 55142
ST. LO.	27	2-22-72	PC 55142
ST. LO.	28	2-22-72	PC 55142
ST. LO.	29	2-22-72	PC 55142
ST. LO.	30	2-22-72	PC 55142
ST. LO.	31	2-22-72	PC 55142
ST. LO.	32	2-22-72	PC 55142
ST. LO.	33	2-22-72	PC 55142
ST. LO.	34	2-22-72	PC 55142
ST. LO.	35	2-22-72	PC 55142
ST. LO.	36	2-22-72	PC 55142
ST. LO.	37	2-22-72	PC 55142
ST. LO.	38	2-22-72	PC 55142
ST. LO.	39	2-22-72	PC 55142
ST. LO.	40	2-22-72	PC 55142
ST. LO.	41	2-22-72	PC 55142
ST. LO.	42	2-22-72	PC 55142
ST. LO.	43	2-22-72	PC 55142
ST. LO.	44	2-22-72	PC 55142
ST. LO.	45	2-22-72	PC 55142
ST. LO.	46	2-22-72	PC 55142
ST. LO.	47	2-22-72	PC 55142
ST. LO.	48	2-22-72	PC 55142
ST. LO.	49	2-22-72	PC 55142
ST. LO.	50	2-22-72	PC 55142
ST. LO.	51	2-22-72	PC 55142
ST. LO.	52	2-22-72	PC 55142
ST. LO.	53	2-22-72	PC 55142
ST. LO.	54	2-22-72	PC 55142
ST. LO.	55	2-22-72	PC 55142
ST. LO.	56	2-22-72	PC 55142
ST. LO.	57	2-22-72	PC 55142
ST. LO.	58	2-22-72	PC 55142
ST. LO.	59	2-22-72	PC 55142
ST. LO.	60	2-22-72	PC 55142
ST. LO.	61	2-22-72	PC 55142
ST. LO.	62	2-22-72	PC 55142
ST. LO.	63	2-22-72	PC 55142
ST. LO.	64	2-22-72	PC 55142
ST. LO.	65	2-22-72	PC 55142
ST. LO.	66	2-22-72	PC 55142
ST. LO.	67	2-22-72	PC 55142
ST. LO.	68	2-22-72	PC 55142
ST. LO.	69	2-22-72	PC 55142
ST. LO.	70	2-22-72	PC 55142
ST. LO.	71	2-22-72	PC 55142
ST. LO.	72	2-22-72	PC 55142
ST. LO.	73	2-22-72	PC 55142
ST. LO.	74	2-22-72	PC 55142
ST. LO.	75	2-22-72	PC 55142
ST. LO.	76	2-22-72	PC 55142
ST. LO.	77	2-22-72	PC 55142
ST. LO.	78	2-22-72	PC 55142
ST. LO.	79	2-22-72	PC 55142
ST. LO.	80	2-22-72	PC 55142
ST. LO.	81	2-22-72	PC 55142
ST. LO.	82	2-22-72	PC 55142
ST. LO.	83	2-22-72	PC 55142
ST. LO.	84	2-22-72	PC 55142
ST. LO.	85	2-22-72	PC 55142
ST. LO.	86	2-22-72	PC 55142
ST. LO.	87	2-22-72	PC 55142
ST. LO.	88	2-22-72	PC 55142
ST. LO.	89	2-22-72	PC 55142
ST. LO.	90	2-22-72	PC 55142
ST. LO.	91	2-22-72	PC 55142
ST. LO.	92	2-22-72	PC 55142
ST. LO.	93	2-22-72	PC 55142
ST. LO.	94	2-22-72	PC 55142
ST. LO.	95	2-22-72	PC 55142
ST. LO.	96	2-22-72	PC 55142
ST. LO.	97	2-22-72	PC 55142
ST. LO.	98	2-22-72	PC 55142
ST. LO.	99	2-22-72	PC 55142
ST. LO.	100	2-22-72	PC 55142

BANKERS TRUST PLAZA

A FISHER BROTHERS PROJECT

GREENWICH AND LIBERTY ST. N. Y. N. Y.

SHREVE, LAMB & HARMON ASSOCIATES PC ARCHITECTS
475 PARK AVENUE SOUTH N. Y. N. Y. 10016

PETERSON AND BRICKBAUER ASSOCIATED ARCHITECTS
919 THIRD AVENUE N. Y. N. Y. 10022

THE OFFICE OF JAMES RUDERMAN STRUCTURAL ENGINEERS
315 MADISON AVENUE N. Y. N. Y. 10022

J. A. ROSS, B. A. W. & B. OLLE S MECH. & ELEC. ENGINEERS
345 PARK AVENUE N. Y. N. Y. 10022

PROJECT NUMBER: **7101**

DRAWING NUMBER: **A16**

DATE: **10/1/72**

SCALE: **1/8" = 1'-0"**

CONSTRUCTION

10/1/72

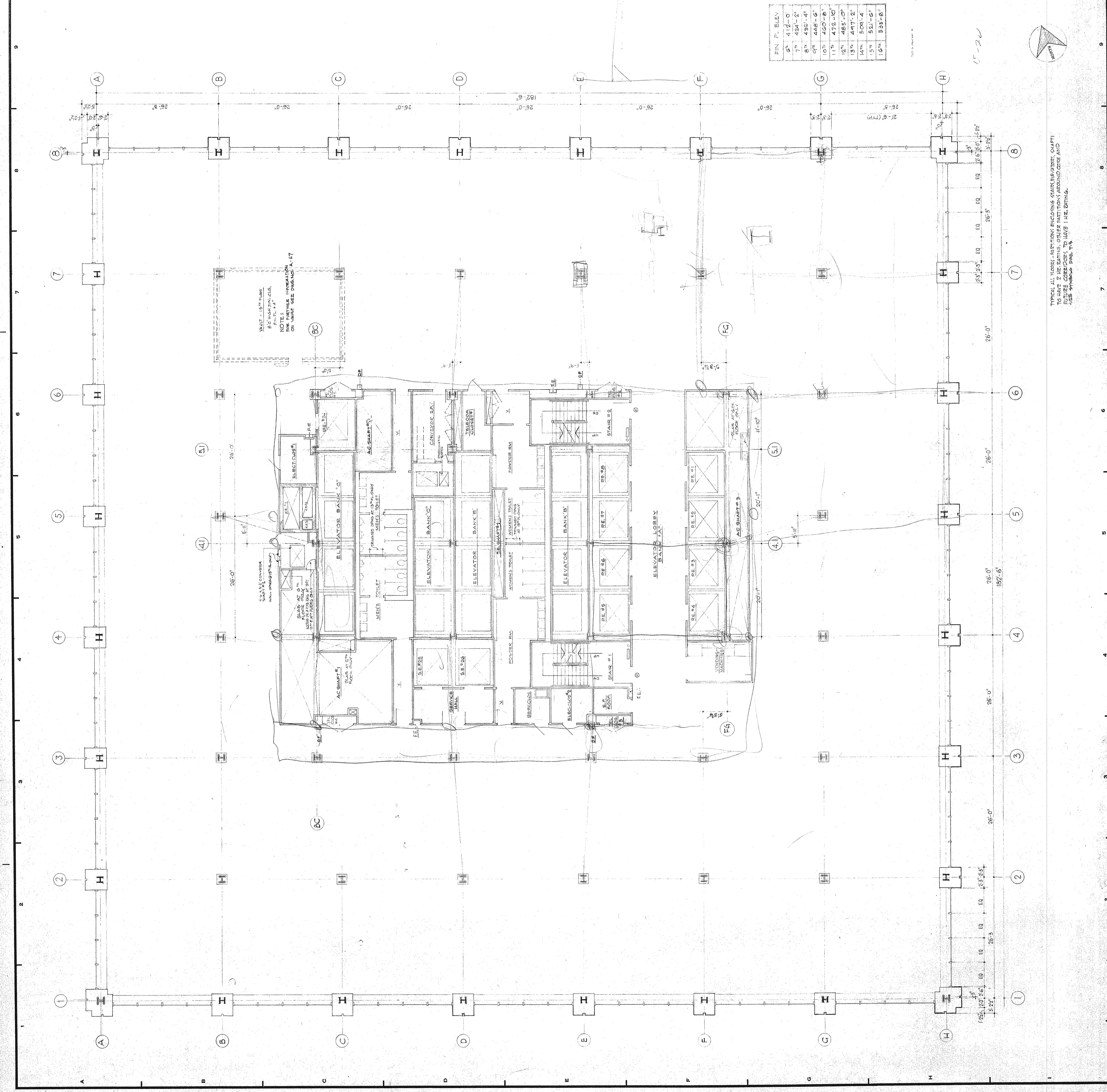

FIN. F. ELEV.	ELEV.
6	412'-0"
7	424'-0"
8	436'-0"
9	448'-0"
10	460'-0"
11	472'-0"
12	484'-0"
13	496'-0"
14	508'-0"
15	520'-0"
16	532'-0"

TYPICAL ALL DIMENSIONS SHOWN IN THIS DRAWING ARE TO FACE UNLESS OTHERWISE NOTED. DIMENSIONS TO FACE ARE SHOWN IN PARENTHESES.