

NO.	DATE	DESCRIPTION
1	12-13-72	REVISED DRAWING PER CITY ENGINEER'S COMMENTS
2	3-14-73	ADDED DRIVEWAY FROM BRANCH BANK TO CITY PROPERTY LINE. REVISED DRIVEWAY ON LIBERTY ST. AND WITHIN CITY PROPERTY LINE. REVISED DRIVEWAY FROM BRANCH BANK TO CITY PROPERTY LINE. REVISED DRIVEWAY FROM BRANCH BANK TO CITY PROPERTY LINE.

ISSUED TO	NO.	DATE	PKG. NO.
REVISION	1	11-09-72	1
CONV. ELECT.	2	11-09-72	2
HIGHWAYS	3	11-09-72	3
HIGHWAYS	4	11-09-72	4
REVISION	5	11-09-72	5
CONV. ELECT.	6	11-09-72	6
HIGHWAYS	7	11-09-72	7
HIGHWAYS	8	11-09-72	8
REVISION	9	11-09-72	9
CONV. ELECT.	10	11-09-72	10
HIGHWAYS	11	11-09-72	11
HIGHWAYS	12	11-09-72	12
REVISION	13	11-09-72	13
CONV. ELECT.	14	11-09-72	14
HIGHWAYS	15	11-09-72	15
HIGHWAYS	16	11-09-72	16
REVISION	17	11-09-72	17
CONV. ELECT.	18	11-09-72	18
HIGHWAYS	19	11-09-72	19
HIGHWAYS	20	11-09-72	20
REVISION	21	11-09-72	21
CONV. ELECT.	22	11-09-72	22
HIGHWAYS	23	11-09-72	23
HIGHWAYS	24	11-09-72	24
REVISION	25	11-09-72	25
CONV. ELECT.	26	11-09-72	26
HIGHWAYS	27	11-09-72	27
HIGHWAYS	28	11-09-72	28
REVISION	29	11-09-72	29
CONV. ELECT.	30	11-09-72	30
HIGHWAYS	31	11-09-72	31
HIGHWAYS	32	11-09-72	32

**BANKERS TRUST  
PLAZA**

**A FISHER BROTHERS  
PROJECT**

GREENWICH AND LIBERTY ST. N.Y. - N.Y.

SHREVE, LAMB & HARMON ASSOCIATES PC  
ARCHITECTS  
475 PARK AVENUE SOUTH N.Y. N.Y. 10016

PETERSON AND BRICKBAUER  
ASSOCIATED ARCHITECTS  
919 THIRD AVENUE N.Y. N.Y. 10022

THE OFFICE OF JAMES RUDERMAN  
STRUCTURAL ENGINEERS  
315 MADISON AVENUE N.Y. N.Y. 10022

J. A. ROSS, BAUM & BOLLE S  
MECH. & ELEC. ENGINEERS  
345 PARK AVENUE N.Y. N.Y. 10022

BLOCK No. 54

PAVING PLAN  
1ST FLOOR NORTH

PROJECT NUMBER	7101
DRAWING NUMBER	A 2
DATE	3-25-72
SCALE	1/8" = 1'-0"

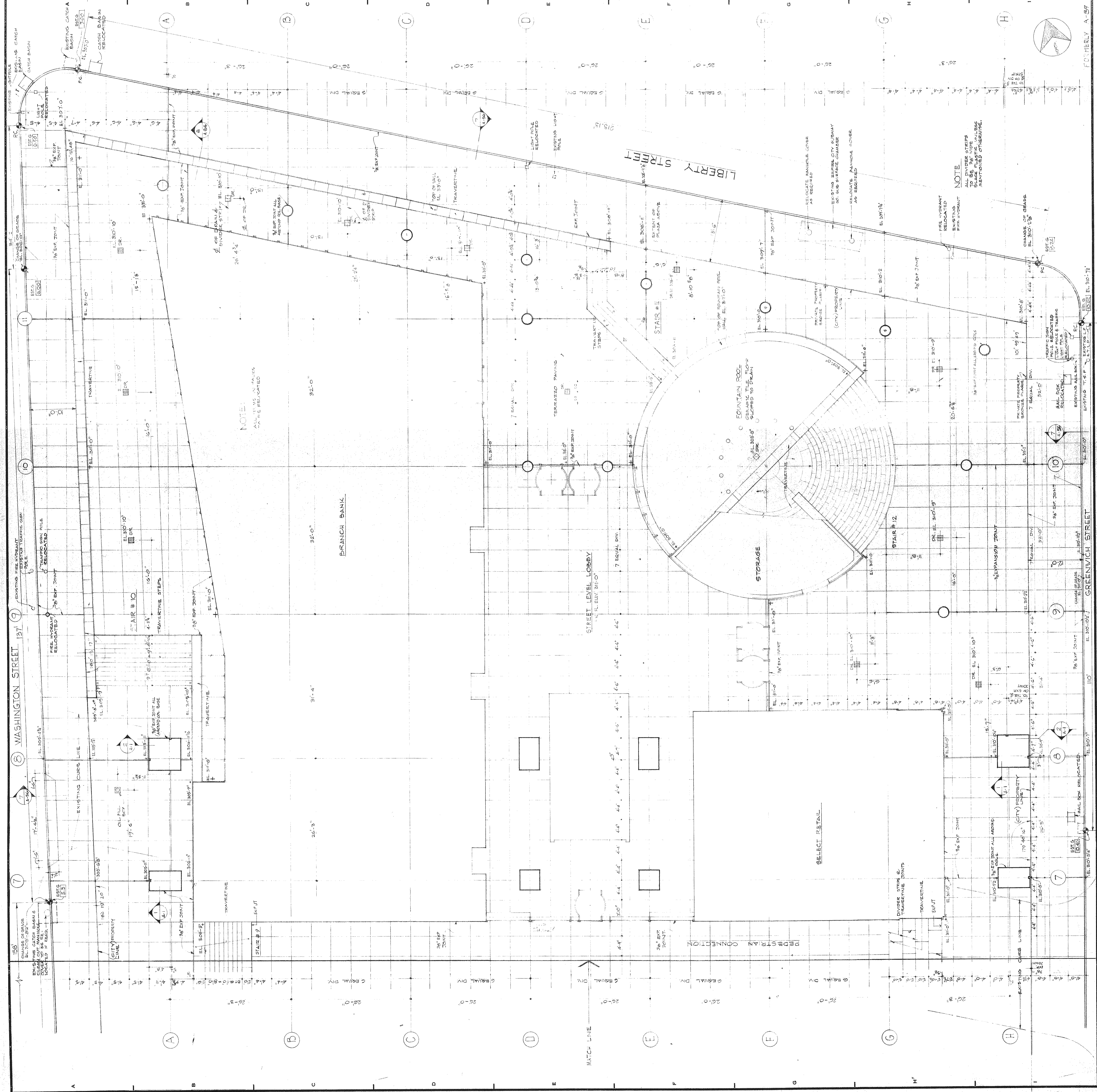

FORMERLY A-57